

FINDER

a **DOVER** company



C2KV-C2KV-B



**Pompe verticali di processo a
norme API 610 - XI edizione
Vertical process pumps according
to API 610 - XI edition Norms**

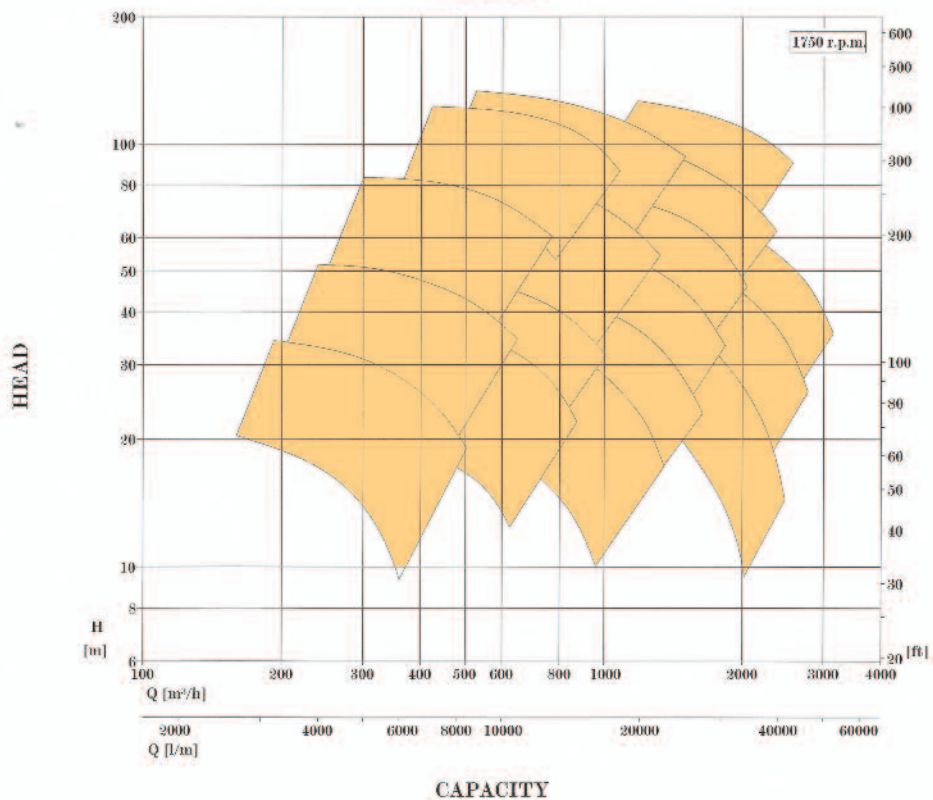
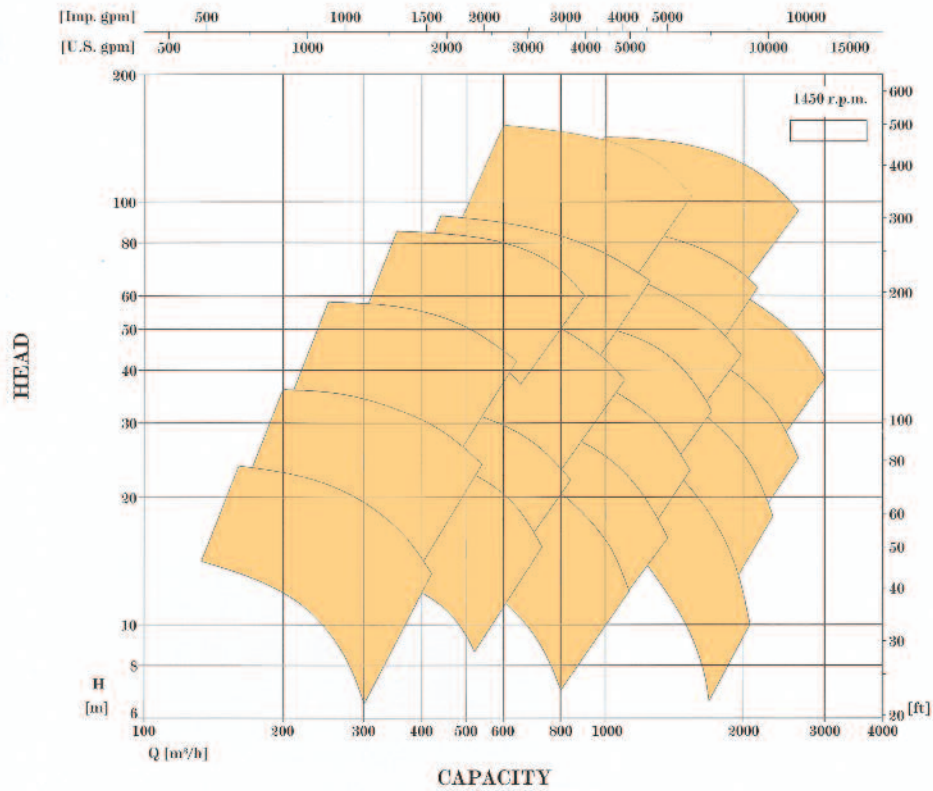

Campo di applicazione:

Portata $\leq 2000 \text{ m}^3/\text{h}$
 Prevalenza $\leq 120 \text{ m}$
 Velocità $\leq 1750 \text{ rpm}$
 Temperatura $\leq 150^\circ\text{C}$
 Max. pressione consentita 24 bar

Field of application:

Flow
 Head
 Speed
 Temperature
 Max. allowable pressure

Le pompe C2KV e C2KV-N sono pompe verticali a doppia aspirazione e doppia voluta, specificatamente studiate per applicazione in oleodotti e impianti petrolchimici.

Le pompe sono realizzate in accordo alle norme API 610, ultima edizione.

Grazie alla loro costruzione, queste pompe consentono di ridurre drasticamente il valore di NPSHr e le spinte assiali,

Sono disponibili tutti i materiali costruttivi in accordo alla normativa API 610 e metallurgie speciali per applicazioni dove sia richiesta particolare resistenza alla erosione e/o corrosione.

C2KV and C2KV-N pumps are double suction twin volute vertical wet pit pumps specifically designed for oil pipelines and petro-chemical applications.

They are designed according to API 610, latest edition norms.

Thanks to their specific construction, these pumps strongly reduce NPSHr value and the axial thrust value, thus increasing bearing life and pump reliability.

All materials combination as per API 610 material tables plus erosion/corrosion resistant alloys are available

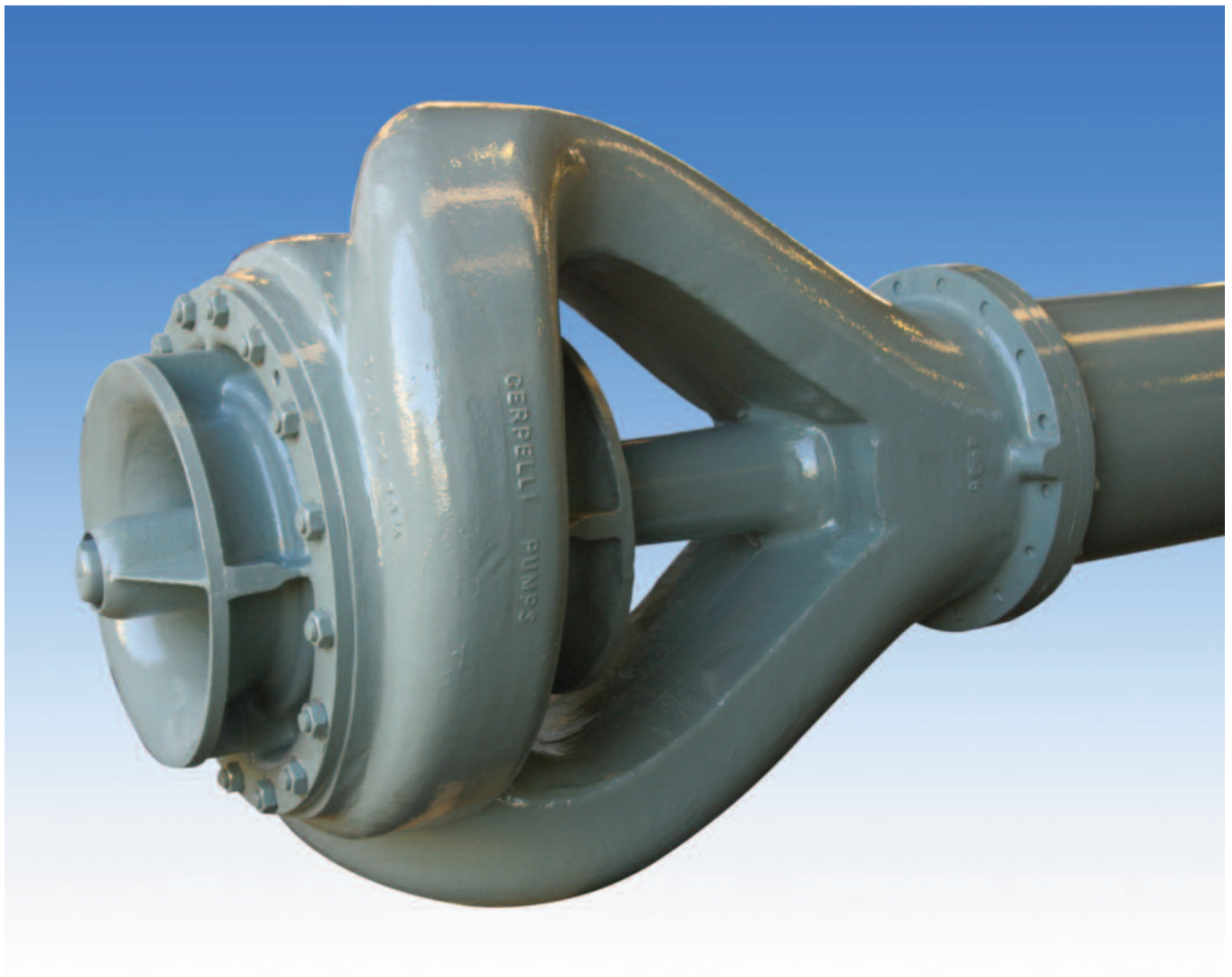

FINDER

a **DOVER** company



Finder Pompe S.r.l.

23807 MERATE (Lc) - ITALY

Via Bergamo, 65

Tel. +39 039 9982.1

Fax +39 039 599267

e-mail: finder@finderpumps.com

Internet: www.finderpumps.com

www.finderpumps.com